



XC 65-50-200 / 15

- Motor power P₂: 15kW
- Impeller nominal diameter: 200mm
- Outlet flange: DN50
- Inlet flange: DN65
- XC series stainless steel centrifugal pump (close coupled)

Performance curves(2900r/min)

Model	Power P ₂ (kW)	Flow Q(m ³ /h)	Head H(m)
XC 50-32-160/1.1	1.1	12.5	18
XC 50-32-160/1.5	1.5		22
XC 50-32-160/2.2	2.2		28
XC 50-32-200/3.0	3.0		33
XC 50-32-200/4.0	4.0		45
XC 50-32-200/5.5	5.5		55
XC 65-40-125/1.5	1.5	25	14
XC 65-40-125/2.2	2.2		20
XC 65-40-125/3.0	3.0		25
XC 65-40-160/4.0	4.0		30
XC 65-40-200/5.5	5.5		38
XC 65-40-200/7.5	7.5		48
XC 65-40-200/11	11.0		63
XC 65-50-125/3.0	3.0	50	13
XC 65-50-125/4.0	4.0		18
XC 65-50-160/5.5	5.5		25
XC 65-50-200/7.5	7.5		32
XC 65-50-200/9.2	9.2		40
XC 65-50-200/11	11.0		48
XC 65-50-200/15	15.0		58
XC 65-50-200/18.5	18.5		68

Feature:

- ◆ Pump case adopt new manufacture technic as hydroforming, a volute fluid-flow design to achieve more efficiency.
- ◆ A widely applications to transfer different mediums
- ◆ Motor drawn out from pump design is easy for taking off the impeller without piping removal.
- ◆ standard DIN flange connection.
- ◆ reliable construction and compact design.
- ◆ wide performance scope.
- ◆ Wet-end is all made from SUS304 material.

Applications:

- ◆ Civil, agricultural and Industrial water supplying system.
- ◆ Making wine and Food system.
- ◆ Central heating and airconditioner system.
- ◆ Fire extinguisher system.
- ◆ Main pipe pressurizing.
- ◆ Cooling tower.
- ◆ Cleaning system.
- ◆ Swimming pool.
- ◆ Transporting industrial liquid .
- ◆ Draining and irrigating.

Motor:

2-Pole or 4-Pole asynchronous motor
Protection class IP55, Insulation class F
Single phase motor:

Power ≤ 1.5kW, 220V, 50Hz

Three-phase motor:

Power ≤ 4.0kW, 220V/380V, 50Hz

Three-phase motor:

Power ≥ 5.5kW, 380V/660V, 50Hz

The maximum of performance

Max flow: 70m³/h

Max head: 70m

Max operation pressure: 10bar

Liquid temperature: Normal type: 5~70°C

High temperature: 5~104°C

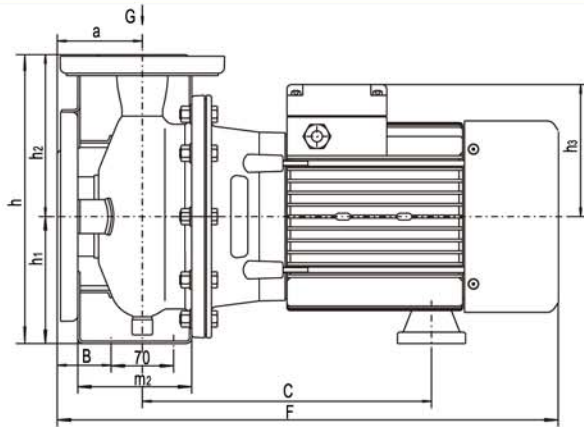

Installation Struction(1.1~15kW)

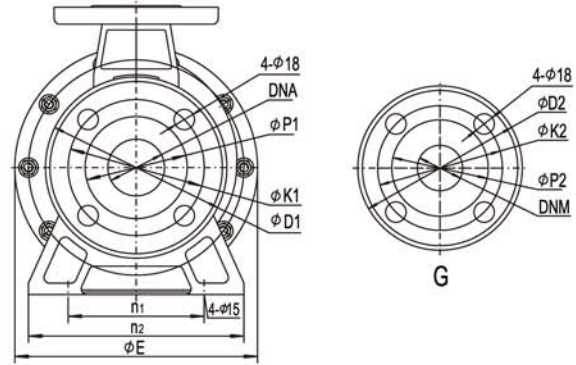

Model	Power P ₂ (kW)	φ E	F	h	h ₁	h ₂	h ₃	a	m ₂	n ₁	n ₂	B	C	φ D1	φ k1	φ P1	φ D2	φ K2	φ P2	DNA	DNM
XC 50-32-160/1.1	1.1	210	395	255	112	143	134	80	115	160	190	45	215	165	125	96	140	100	76	50	32
XC 50-32-160/1.5	1.5	210	395	255	112	143	134	80	115	160	190	45	215	165	125	96	140	100	76	50	32
XC 50-32-160/2.2	2.2	210	428	255	112	143	119	80	115	160	190	45	245	165	125	96	140	100	76	50	32
XC 50-32-200/3.0	3.0	300	460	340	160	180	119	80	118	190	240	45	245	165	125	96	140	100	76	50	32
XC 50-32-200/4.0	4.0	300	498	340	160	180	142	80	118	190	240	45	257	165	125	96	140	100	76	50	32
XC 50-32-200/5.5	5.5	300	532	340	160	180	162	80	118	190	240	45	272	165	125	96	140	100	76	50	32
XC 65-40-125/1.5	1.5	210	395	255	112	143	134	80	115	160	190	45	215	185	145	115	150	110	80	65	40
XC 65-40-125/2.2	2.2	210	425	255	112	143	119	80	115	160	190	45	245	185	145	115	150	110	80	65	40
XC 65-40-125/3.0	3.0	250	460	292	132	160	119	80	118	190	240	45	245	185	145	115	150	110	80	65	40
XC 65-40-160/4.0	4.0	250	498	292	132	160	142	80	118	190	240	45	258	185	145	115	150	110	80	65	40
XC 65-40-200/5.5	5.5	300	554	360	160	200	162	100	118	212	264	65	274	185	145	115	150	110	80	65	40
XC 65-40-200/7.5	7.5	300	592	360	160	200	162	100	118	212	264	65	274	185	145	115	150	110	80	65	40
XC 65-40-200/11	11	300	623	360	160	200	179	100	118	212	264	65	335	185	145	115	150	110	80	65	40
XC 65-50-125/3.0	3.0	250	455	292	132	160	119	80	115	190	240	45	245	185	145	115	165	125	96	65	50
XC 65-50-125/4.0	4.0	250	498	292	132	160	142	80	115	190	240	45	258	185	145	115	165	125	96	65	50
XC 65-50-160/5.5	5.5	300	554	360	160	200	162	100	118	212	264	65	274	185	145	115	165	125	96	65	50
XC 65-50-200/7.5	7.5	300	592	360	160	200	162	100	118	212	264	65	274	185	145	115	165	125	96	65	50
XC 65-50-200/9.2	9.2	300	623	360	160	200	179	100	118	212	264	65	335	185	145	115	165	125	96	65	50
XC 65-50-200/11	11	300	623	360	160	200	179	100	118	212	264	65	335	185	145	115	165	125	96	65	50
XC 65-50-200/15	15	300	665	360	160	200	179	100	118	212	264	65	335	185	145	115	165	125	96	65	50

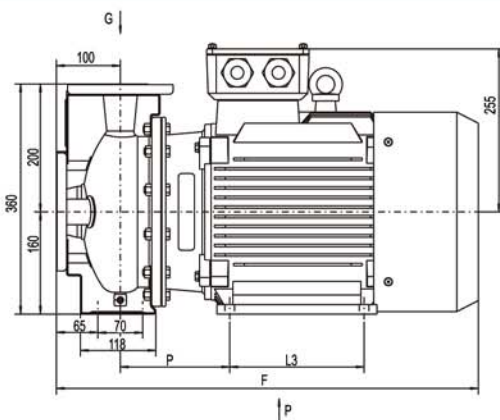

Installation Struction(18.5kW)

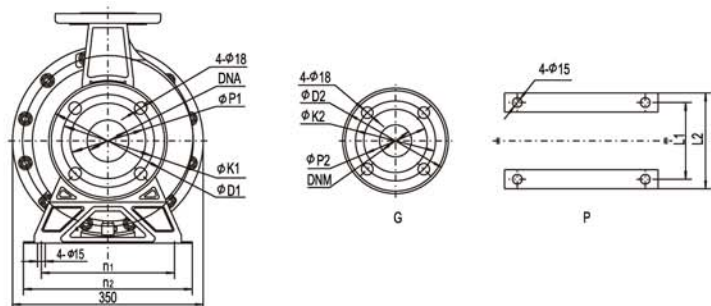

Model	Power P ₂ (kW)	F	n ₁	n ₂	P	L ₁	L ₂	L ₃	φ D1	φ k1	φ P1	φ D2	φ K2	φ P2	DNA	DNM
XC 65-50-200/18.5	18.5	725	212	264	175	254	320	254	185	145	115	165	125	96	65	50